



motorino restaurants



WELCOME TO MOTORINO NORTH

Enoteca describes a popular, established, local restaurant and bar that has a range of high quality wines. Motorino Enoteca is founded on these hospitality elements that were brought from Italy and introduced to the Greater Toronto Area through our six locations and counting.

An inviting and friendly atmosphere, hospitable service, and delicious cuisine are components essential to the success of today's corporate and social catering events.

Our new Event Prix Fixe Menu, Catering Menu and Dining Menu deliver traditional, wholesome Italian flavours with a modern twist, preserving the values we hold to use organic ingredients that come from local farms in Ontario and directly to your plates.

We strive to continuously surpass the standards we have set for ourselves. It is not enough for us to meet client expectations, we must exceed them.

On behalf of the Motorino Restaurants & Cucina Catering Team, we look forward to working with you in creating special events and memorable occasions.

Ci Vediamo

*Ciao,
Come ride
with us!*

VENUE CAPACITY INFORMATION

MOTORINO NORTH (INSIDE)

Venue Size: 5,000 Square Feet
Venue Capacity: 220 Guests
Sit Down Dinner: 150 Guests
Reception Style: 200 guests

PATIO

Reception Style: 100 Guests
Sit Down Dinner: 75 Guests
(Minimum Spend: Half Patio | Full Patio
\$1,000 | \$2,000)
Available all year
(fully enclosed and heated)

NAPLES SECTION

Reception Style: 70 Guests
Sit Down Dinner: 50 Guests
(Minimum Spend: \$1,500)

ROME PRIVATE DINING ROOM

Kings Table Sit Down Dinner: 22 Guests
U-Shape: 20 Guests
2 Rows of Ten Top Tables: 20 Guests
(Minimum spend: \$1,500)

TUSCANY TERREACE

Reception Style: 40 Guests
Sit Down Dinner Harvest Table: 24 Guests
Sit Down Dinner: 30 Guests
(Minimum Spend: \$1,000)

ROME PRIVATE DINING ROOM & TUSCANY TERRACE

Reception Style: 60 Guests
Sit Down Dinner: varies on table
arrangements
(Minimum Spend: \$2,000)

CALABRIA SECTION

Reception Style: 30 Guests
Sit Down Dinner Harvest Table: 12 Guests
Sit Down Dinner: 6, 8 & 12 Top Tables for a
total of 26 guests
(Minimum Spend: \$1,000)



LAMB SHANK



IMPORTED ITALIAN BEER



ROME PRIVATE DINING ROOM





motorino restaurants

Collaborate. Share. Inspire.  1700 King Rd, King City, ON L7B 0N1

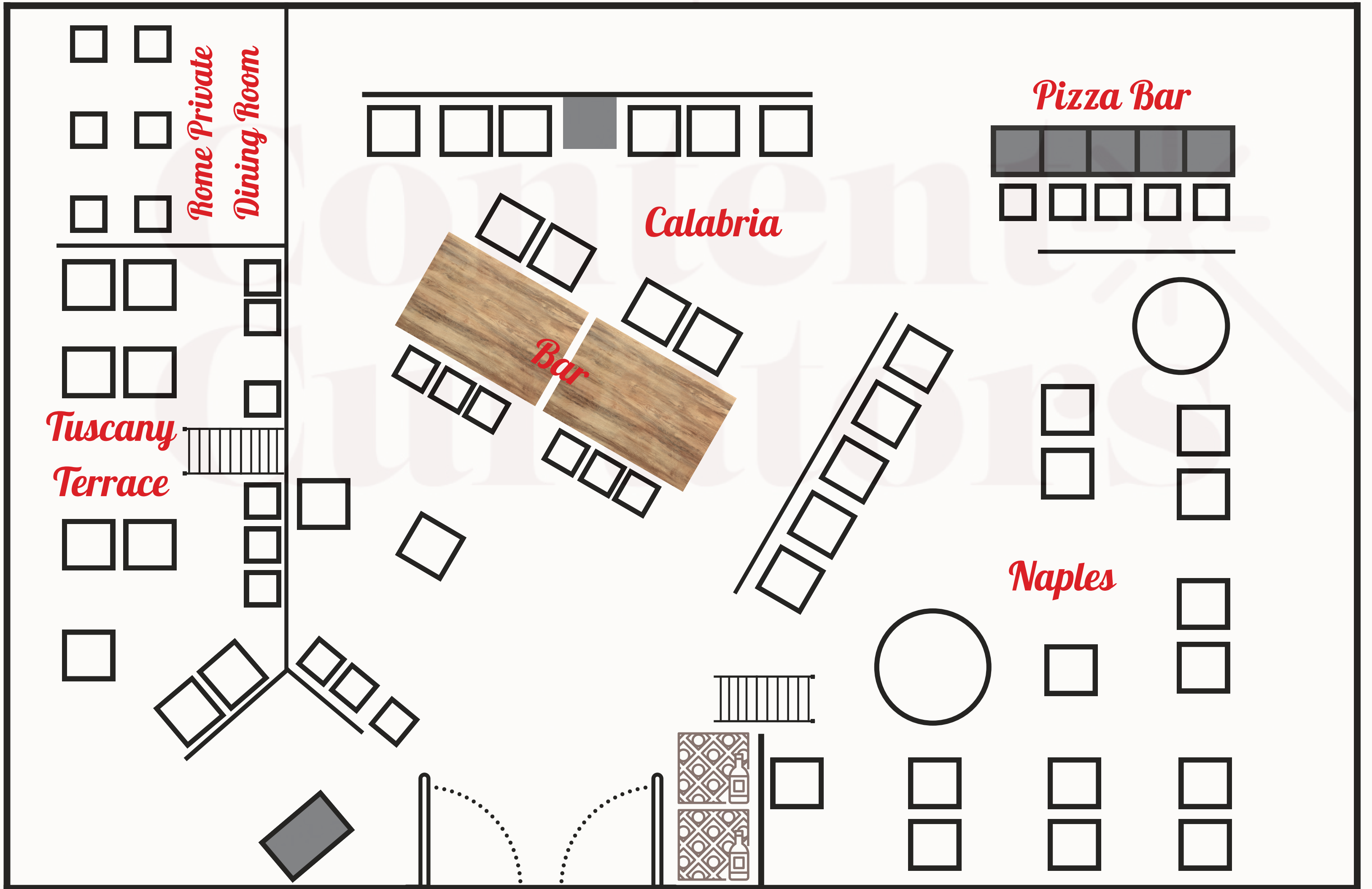

Patio: 75 Seats, Located on the South Side of Building | Heated in the Winter Season

MOTORINO RESTAURANTS LOCATIONS



1700 KING RD, KING CITY ★



466 ADELAIDE ST. E, TORONTO



ADELAIDE, TORONTO



7600 WESTON ROAD, VAUGHAN



4101 RUTHERFORD RD, VAUGHAN



COMMISSARY KITCHEN



AVENUE, NORTH YORK



CONTACT

MOTORINO RESTAURANTS NORTH

Please Contact a Manager Regarding your Upcoming Event Inquiry

R. 905-833-6686
E. north@motorinotenoteca.com

motorinotenoteca.com